

Kabin Ölçüleri
Cabinet Dimensions

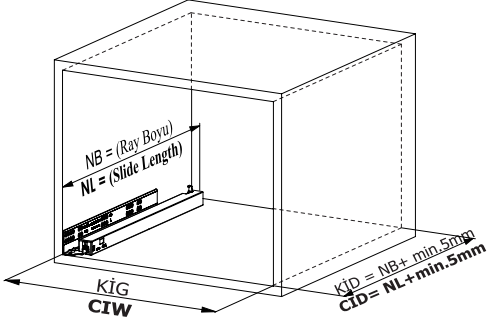

Kabin İç Geniřliđi	: KIĞ	Cabinet Internal Width	: CIW
Kabin İç Derinliđi	: KİD	Cabinet Internal Depth	: CİD
Çekmece Derinliđi	: ÇD	Drawer Depth	: DD
Çekmece İç Geniřliđi	: ÇİĞ	Drawer Internal Width	: DİW
Nominal Boy (Ray boyu): NB		Nominal Length	: NL

Tavsiye Edilen Vıda ve Şablonlar
Recommended Screw and Templates

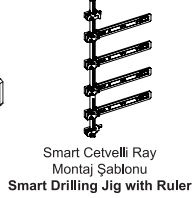
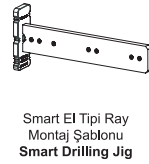
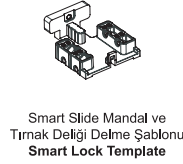
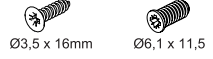

Rayların Vıda Konum Ölçüleri
Screw Location for the Slides

Rayı, koyu renk ile işaretlenmiş deliklerden vidalayınız.
Screw the slide from marked holes.

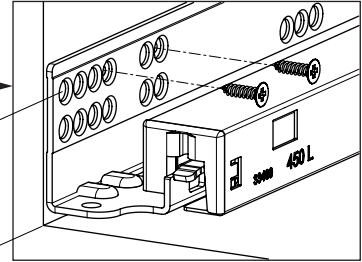
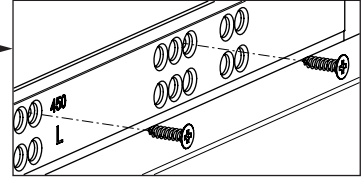
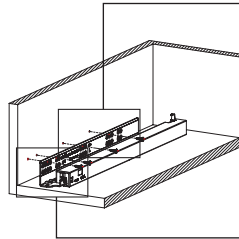
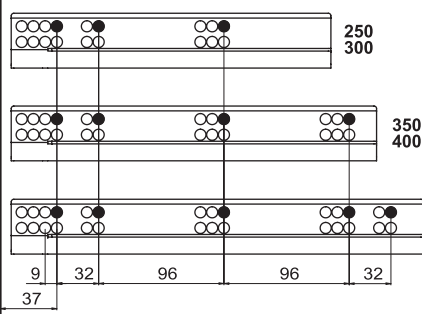

Çekmece Ölçüleri
Drawer Dimensions

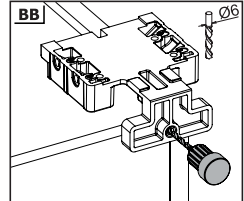
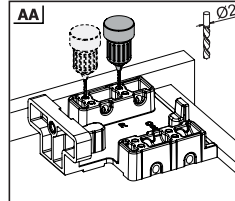
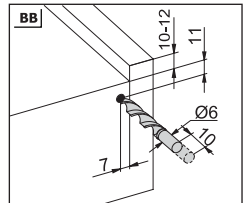
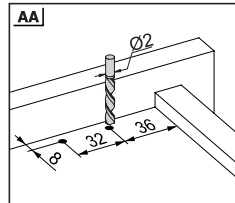
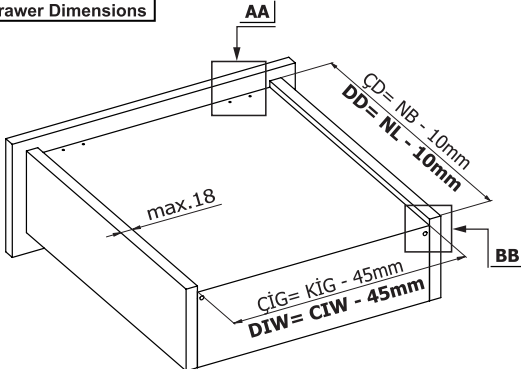

1

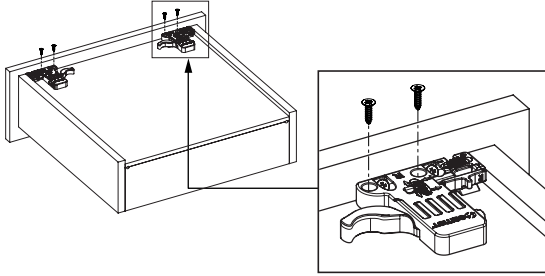

Not: Çekmece taban kalınlığı 12 mm'den küçük olduğunda, açılı mandal bağlama deliklerini kullanınız.

Note: Use angled holes to mount smart lock when wooden floor width is selected less than 12 mm.

AA

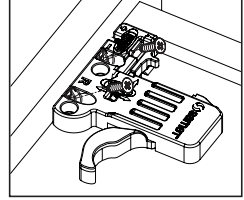
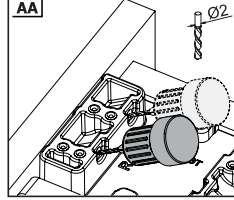

2

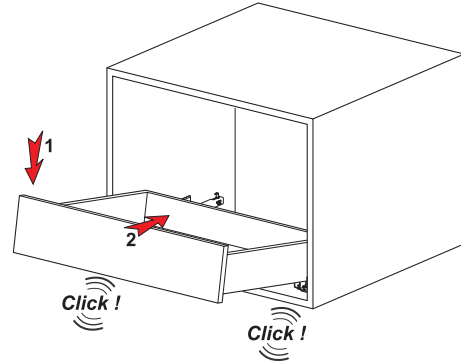

3

Somunu çevirerek, yukarıya doğru ayar yapabilirsiniz.
You may adjust upside positioning by turning the knob.

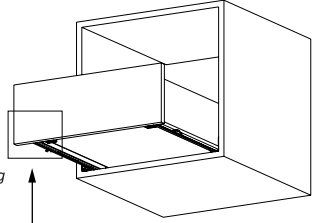
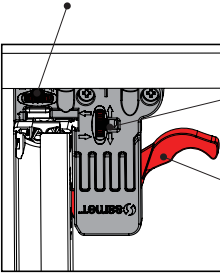

Somunu çevirerek, sağ-sol ayarını yapabilirsiniz.
You may adjust left - right positioning by turning the knob.

Mandal kollarına aynı anda basarak, çekmeceyi kolayca yerinden çıkarabilirsiniz.
You can easily take the drawer out by simply pushing the latch smart lock

Smart El Tipi Ray
Montaj Şablonu
Smart Drilling Jig

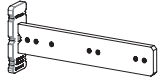

Kod / Code

12799902

12799904

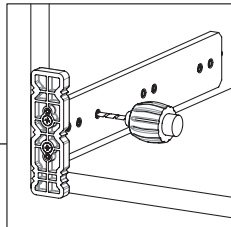
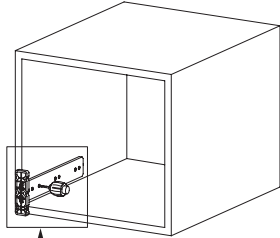

Smart Cetveli Ray
Montaj Şablonu
Smart Drilling Jig with Ruler

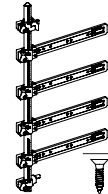

Kod / Code

12799901

12799905

